

TANAKA

COMET SINGLE STAGE REGULATOR

~ for High Purity Industrial Gases ~



Standard Feature

316L Stainless Steel Diaphragm

316 Stainless Steel Mesh Filter

Brass Bar Stock Body with Nickel Plating

Brass Forging Bonnet Cap with Nickel Plating

MPa or bar/psi Scale Pressure Gauges with Stainless Steel Case

Using Temperature 5~40 °C

Safety Valve Equipped

Needle Valve is optional

Push-in Check Marker



Marker does not protrude



Marker protrudes

Model	Inlet Connection	Outlet Connection	Applied Gases	Outlet Pressure	Outlet Gauge	Inlet Gauge
CMH (Single Stage)	CGA - 320	Tube Fitting :-	CO ₂	0~15 psi	[02] : -30" Hg-0-30 psi / 2bar	[B8] : 0~4000 psi (0~280bar)
	- 350	[1/4] : 1/4"	H ₂	0~50 psi	[07] : -30" Hg-0-100 psi / 7bar	
	- 540	[1/8] : 1/8"	O ₂	0~125 psi	[14] : -30" Hg-0-200 psi / 14bar	
	- 580	etc.	N ₂			
	BS - 3	<Option>	Ar			
	- 4	-Needle Valve(M16x1.5RH)				
	- 5	With 1/4" Straight Tube				
	- 8					
	JIS - W22-14RH					
	- W22-14LH					
- W23-14RH						
- 20.9-14LH						

APPEARANCE

Tube Fitting Outlet

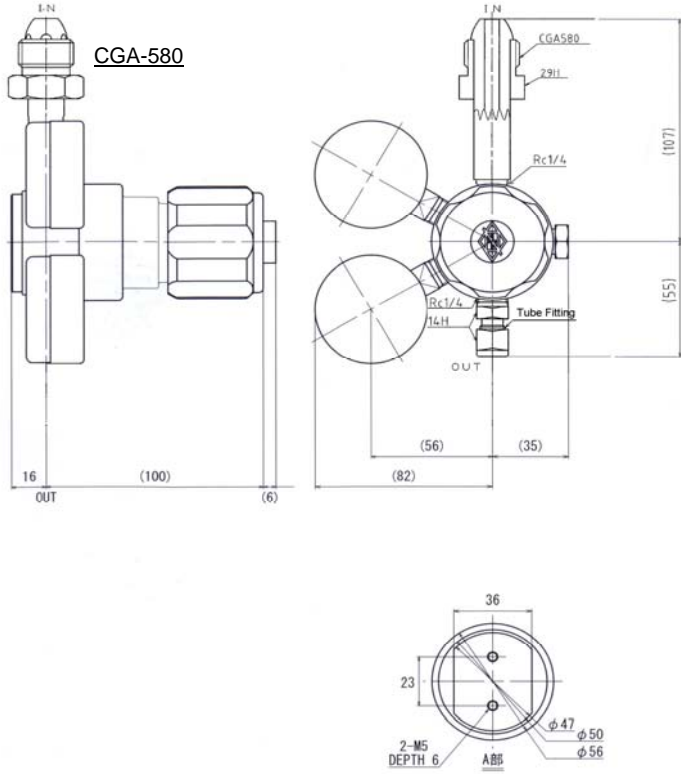

Needle Valve Outlet (Option)

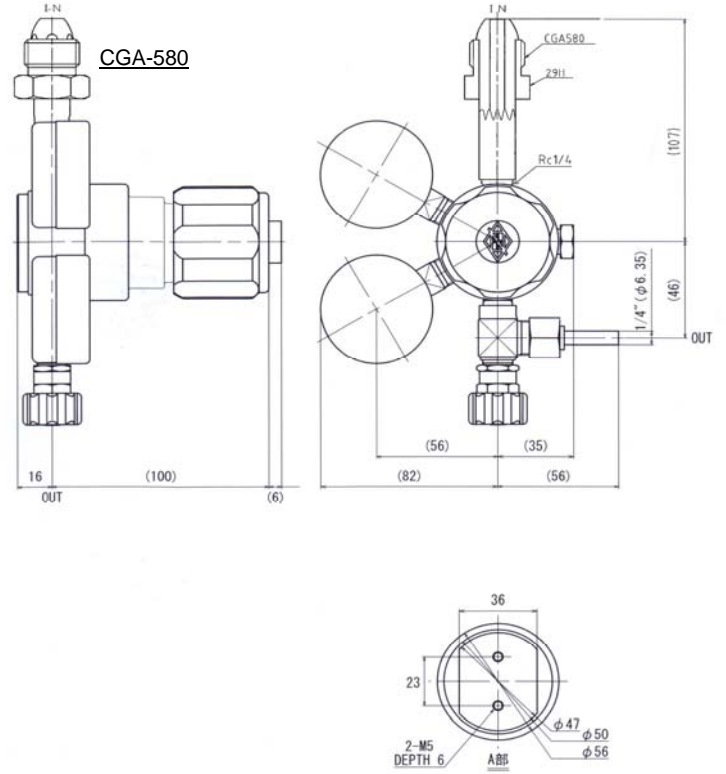

FEATURE

CMH-B503流量特性(N2ガス)

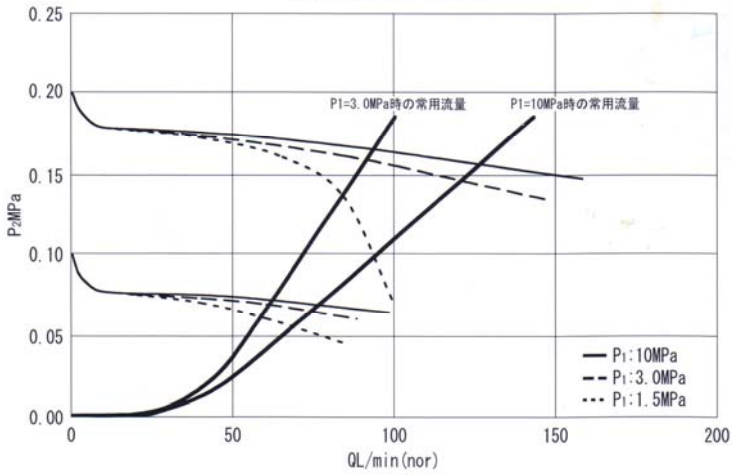

CMH-B506/B510/B515流量特性(N2ガス)

